

Victoria Square

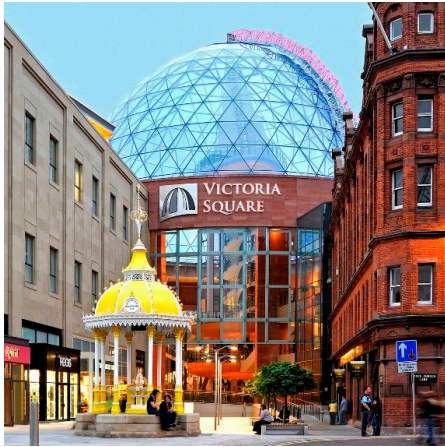

Victoria Square is THE place in Belfast if you want to treat yourself! This shopping centre is huge – you will definitely find something that you'll love in there as there are over seventy international and local brands plus a cinema.

Want to purchase a sweatshirt and a phone in the same place? Totally possible. Besides, if you are hungry after all this shopping spree, don't worry: a lot of restaurants are awaiting nearby. Victoria Square is the perfect place to spend a really good time with your friends and family.

Justine BOULY

Belfast Castle



This famous edifice hosts weddings & other events. At the top of the castle, restaurants have been built, from which visitors can enjoy stunning views of the gardens surrounding the castle. The façade of the castle is reminiscent of a fairy-tale castle.

Camille COQUEREL

Metropolitan Arts Centre

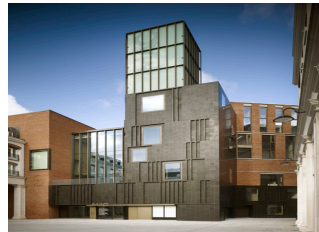

The MAC opened in Belfast in 2012. It is an arts venue with a huge interior arranged into several buildings which offer visitors various art exhibitions of all sorts and theatre performances. You could also attend beautiful dancing shows inside the museum.

Anthony GIROIX



BELFAST

Welcome to a wonderful city to visit !

St Anne's Cathedral



St Anne's Cathedral, also known as Belfast Cathedral, is the focal point of the Cathedral Quarter in Belfast. Built in 1899 by architect Sit Thomas Drew, this magnificent edifice was completed in 1904. It is a beautiful place to visit, in which you can admire two memorials - Edward Carson's and a military one. Moreover, you will not help but gazing at its big colourful stained-glass windows as well as the many historical artefacts

Keep also in mind that St Anne's Cathedral is both an place of Anglican worship and a really popular Catholic sight which attracts thousands of tourists.

Charlotte COUDERT

Botanic Gardens



The Botanic Gardens is a public park to be found on the Lagan riverbank. Created in 1828 this venue was known as "the Royal Belfast Botanic Gardens".

This outdoor tourist sight gathers and protects a lot of specimens of plants and trees, many of which are rare and uncommon.

This park is public and accessible to everyone!

Myriam JEANTET

Titanic Museum

The Titanic Belfast Museum is a visitor attraction dedicated to the RMS Titanic. It is located in the exact same place as where the ship was built - in 1912 - to pay tribute to the shipwreck.



Opened in March 2012 for the hundredth anniversary of the disaster, it allows us to discover the story of the 'unsinkable' ship thanks to its massive exhibition of photographs, plans and footage.

Elodie COUTEUR

Stormont Parliament Buildings



The Stormont Buildings are an edifice built in 1932 which accommodated the Parliament of Northern Ireland until 1972. During the Second World War, the Senate chamber was used by the Royal Air Force as an operating room.

Actually, it is in this very place that today's Northern Irish assembly sits every week.

Amy BABIN-BRISSIERES

